

LIFTLUX

SL205-25/ SL260-25/ SL320-30

The maxi range

 **DIESEL**
Diesel Platform



Manœuvrability



Stability



Durability



LIFTLUX
POTAIN GMBH 

Think Bigger

High stability...

Triple Scissor Mechanism:

The LIFTLUX Triple scissor arm design provides the elevated platform a unique stiffness & lateral rigidity. The machine is more stable, providing more comfort for the user, a better security and an increased work load capacity.



Big extension...

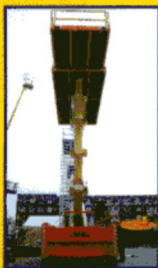

Big lifting capacity:

All units have a big single hydraulic extension deck to increase work space, providing more outreach than twin decks, with no reduction of the overall lift capacity (1,000 to 1,400 kg) and with an important load on the extension.

High manoeuvrability...

Greater terrainability:

LIFTLUX machines are delivered standard with permanent 4 wheel drive, rear oscillating axle, differential lock and wide foam filled tyres for improved rough terrain capability.



Outriggers...

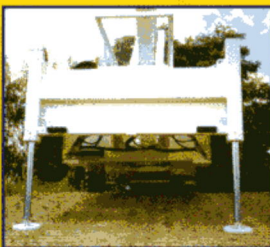

Nivolux:

The patented "NIVOLUX" outrigger device, a unique LIFTLUX feature, allows a perfect (+/-0.1°) automatic self-levelling of the unit on slopes and uneven grounds,

increasing security, reducing the timing and approximate positioning of the jacks. Full height lift is possible without outriggers on flat ground.

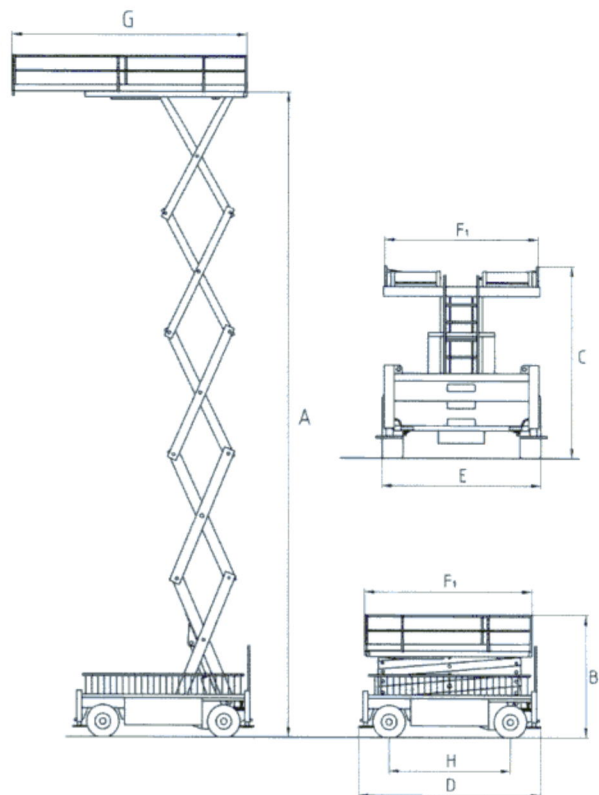

Specifications

| | |
|-------------------------------------|--------------------|
| Working height (m) | 22,5 |
| Platform height (m) | 20,5 A |
| Platform Capacity (Kg) | 1 000 / 800 |
| Overall height (m) | 4,10 B |
| Platform height stowed (m) | 3,00 C |
| Length stowed (m) | 5,70 D |
| Width (m) | 2,55 E |
| Platform size (m) | 5,3 x 2,5 F |
| Platform length fully extended (m) | 7,20 G |
| Wheelbase (m) | 3,90 H |
| Controls | Prop |
| Travel speed (Km/h) | 5,5 |
| Turning radius (m) Inside | 1,25 |
| Outside | 6,0 |
| Lift / Lower (sec) | 90 / 85 |
| Ground clearance (cm) | 30 |
| Gradeability | 25 % |
| Standard drive | 4 x 4 O.A. |
| Fold Down - Take Out platform rails | F.D. |
| Engine - Diesel | Deutz F4L |
| | 58hp |
| Weight (kg) | 14 800 |

Standard Equipment:

- Hydraulic extension deck
- Foam filled tyres
- "Nivolux" Outrigger system
- Hourmeter
- Slope Sensor
- Overload Alarm
- Lateral protection grid (within chassis frame)
- Removable control box
- Fold down railings
- LED indicator on control box for safety features
- Hydraulic brakes
- Proportional drive control
- Motion alarm & travel horn

Options:

- 220V power line on platform
- Air or Water pressure line on platform
- Amber Beacon
- MVS (Data Collection device)
- Narrow 6m platform mounted on SL320-30 deck

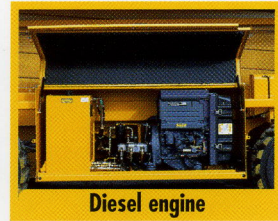

Diesel engine



Fold down rails

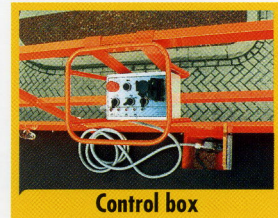

Control box

Access to a world of service...

After Sales Service & Parts

LIFTLUX POTAIN GMBH
DIESELSTRASSE 1
D-66763 DILLINGEN
Tél. +49 (0) 68 31-97 48-0
Fax +49 (0) 68 31-97 48-50

Distributed by :

LIFTLUX
POTAIN GMBH

Think Bigger